

DETAILS OF BLOCK-01 (G+18)

FLOOR	AREA	UNIT
GROUND FLOOR	922.86	SQ. METER
FIRST FLOOR	893.47	SQ. METER
TYPICAL FLOOR 2nd to 18th FLOOR.	892.90X17 =15179.00	SQ. METER
REFUGE AREA	15.00X10=150.00	SQ. METER
TOTAL BUIL UP AREA (BLOCK-01) = 17145.63 SQ. METER		
ABOVE ROOF=5000X6 NOS. = 30000 LITRE.		
UNDER GROUND WATER RESERVOIR 3.650X3.050X2.450=27.30 CUM OR 27300 LITRE =27300X4=1,09,200 LITRE.		

HEIGHT OF PROPOSED BLOCK-01= 56.550 M.

NO OF TENANT EACH FLOOR FROM FIRST TO ALL TYPICAL FLOOR OF BLOCK-01=10 NOS

CAR PARKING (AT G.F.) BLOCK-01=24 NOS AND TWO WHEELER PARKING=21.34X2=42.68 SQ. M.

OPEN ROOF CAR PARKING=284.36 SQ. METER = 30 NOS CAR

TITLE:

PROPOSED G+18 (RUBY CITY CENTRE) OF (A) ANWAR ALI, SON OF LATE MD IDRISH SAIKH (B) CHANDANA DE WIFE OF ANWAR ALI (C) MD AL FAYED ALL, SON OF ANWAR ALI, (D) SAHINA AKHTAR, DAUGHTER OF ANWAR ALI, VILLAGE & POST OFFICE:CHOTO SUJAPUR, UNDER SUJAPUR GRAM PANCHAYET & KALIACHAK-I DEV BLOCK, P.S.: KALIACHAK, DISTRICT: MALDA, PIN CODE :732206.

LAND DESCRIPTION: MOUZA:CHOTO SUJAPUR, JL NO: 117, KH NO: 4943,4942, 10179 & 10180, PLOT NO:318,319,357,358,359,360,360/900, 361,362, AREA: 104.00 DECM.

BLOCK-01  
RESEIDENTIAL  
BUILDING

SHEET DESCRIPTION :  
PLAN SHEET 04/10

SL NO.	DESCRIPTION	CODE	SIZE	REM.
01.	DOOR	ED/CD	1050X2100	
02.	DOOR	D1/PCD1	900X2100	
03.	DOOR	D2	750X2100	
04.	WINDOW	GLW1	1800X1800	
05.	WINDOW	GLW2	1500X1200	
06.	WINDOW	GLW3	900X1200	
07.	WINDOW	GLW4	750X1200	
08.	VENTILATOR	V	600X450	
09.	VENTILATOR	V1	450X450	
10.	STEEL GRILL	SG	1800X2100	
11.	STEEL GRILL	SG1	1500X2100	
09.	STEEL GRILL	SG2	1200X2100	
10.	STEEL GRILL	SG3	1050X2100	

SIGN OF LAND OWNERS & DECLARATION.  
LAND AND OTHER IMPORTANT DOCUMENT  
PROVIDED TO ENGINEER BY ME AND WHICH  
HAVE TRUE AND BEST OF MY KNOWLEDGE.

*Anwar Ali*  
(A) ANWAR ALI,  
(ADHAR NO.: 2883 9596 3835)

*Chandana De*  
(B) CHANDANA DE  
(ADHAR NO.: 7099 1328 4489)

*Md. Afayed Ali*  
(C) MD AL FAYED ALL,  
(ADHAR NO.: 3634 5638 4901)

*Sahina Akhtar*  
(D) SAHINA AKHTAR,  
(ADHAR NO.: 4574 5616 3696)

COUNTER SIGN:

for MALDA PROJECTS P LTD  
*Rishu K. Ghosh*  
Director

SIGN OF ENGINEER/ARCHITECT.

*MD RAFIQU ALAM*  
MD RAFIQU ALAM,  
B. TECH, M TECH (CIVIL/ST)  
MOBILE:7908778589

*Rabeeh Alam*  
RABEEH ALAM,  
STUDENT OF B. ARCH

*Subhajit Goswami*  
SUBHAJIT GOSWAMI,  
B. ARCH

*Subhajit Goswami*  
A. Subhajit Goswami  
Coe No CA/2019/110819  
Reg No-EMM/PWPM-47

Clearance certificate are received from D.R.O.  
H.G. vide memo no 2618-RD-D/RIOP/117-  
18/2014, Dated 30.05.14

*Subhajit Goswami*  
RECOMMENDED  
No: 915/25100/14-15  
885  
Building Plan  
This Plan is valid up to  
24.06.2019 (Five years)

*Subhajit Goswami*  
Assistant Engineer  
& D.O. Design  
Malda City Municipal, Malda

*Subhajit Goswami*  
District Engineer  
Malda City Municipal, Malda

Taken on input  
*Subhajit Goswami*

*Subhajit Goswami*  
SEAL AND SIGNATURE  
OF REGISTERED ARCHITECT  
REGISTERED ARCHITECT  
REGISTERED ARCHITECT  
REGISTERED ARCHITECT  
REGISTERED ARCHITECT  
REGISTERED ARCHITECT  
REGISTERED ARCHITECT  
REGISTERED ARCHITECT  
REGISTERED ARCHITECT  
REGISTERED ARCHITECT

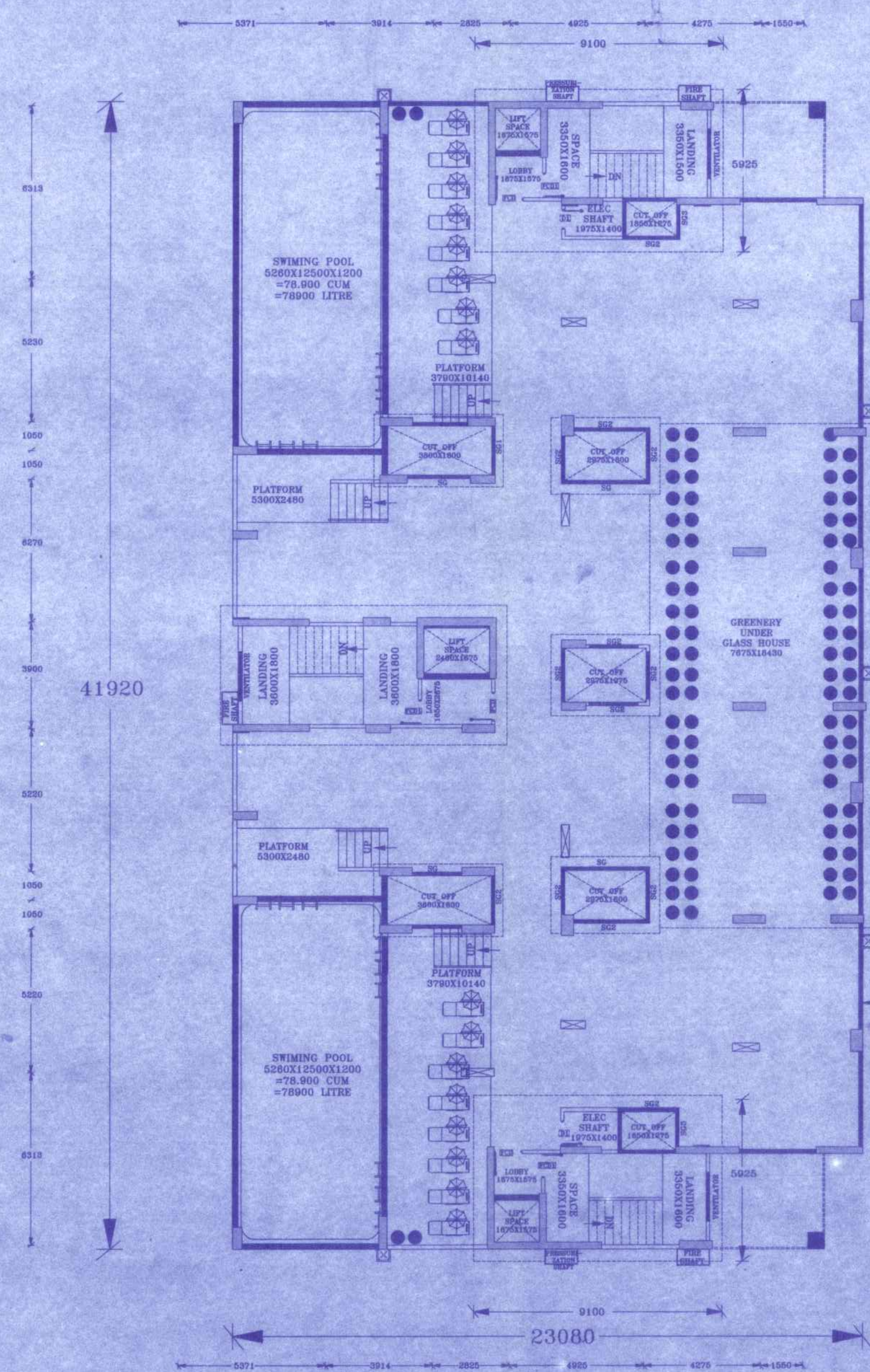

TERRAC PLAN  
SCALE 1:100

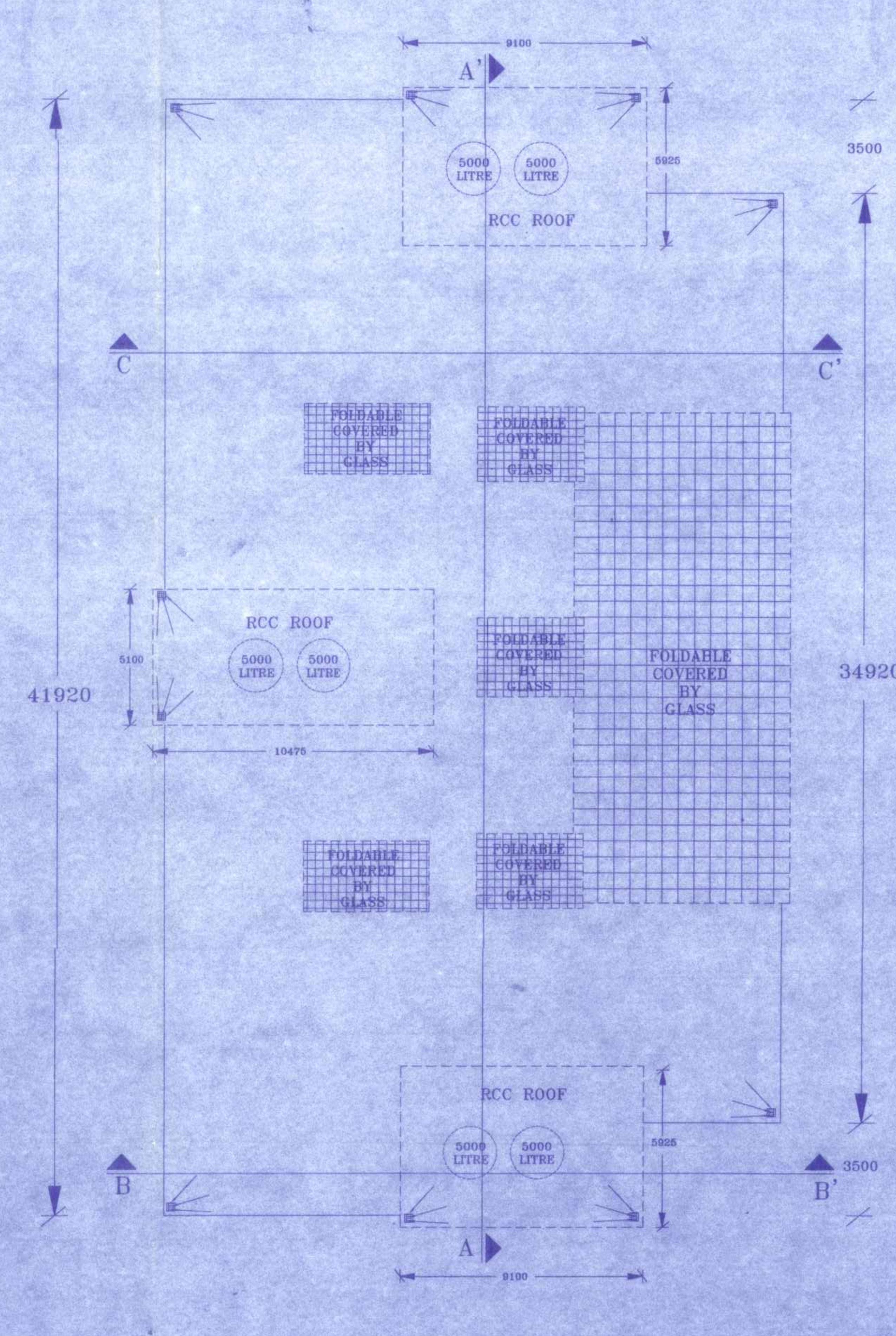

ROOF PLAN  
SCALE 1:100

N.B: ALL DIMENSION ARE IN MM  
STAIR RISER =150mm  
AND TREAD =300mm